

# Tuff Curb® XLP

## Extreme Low Profile Curbing System

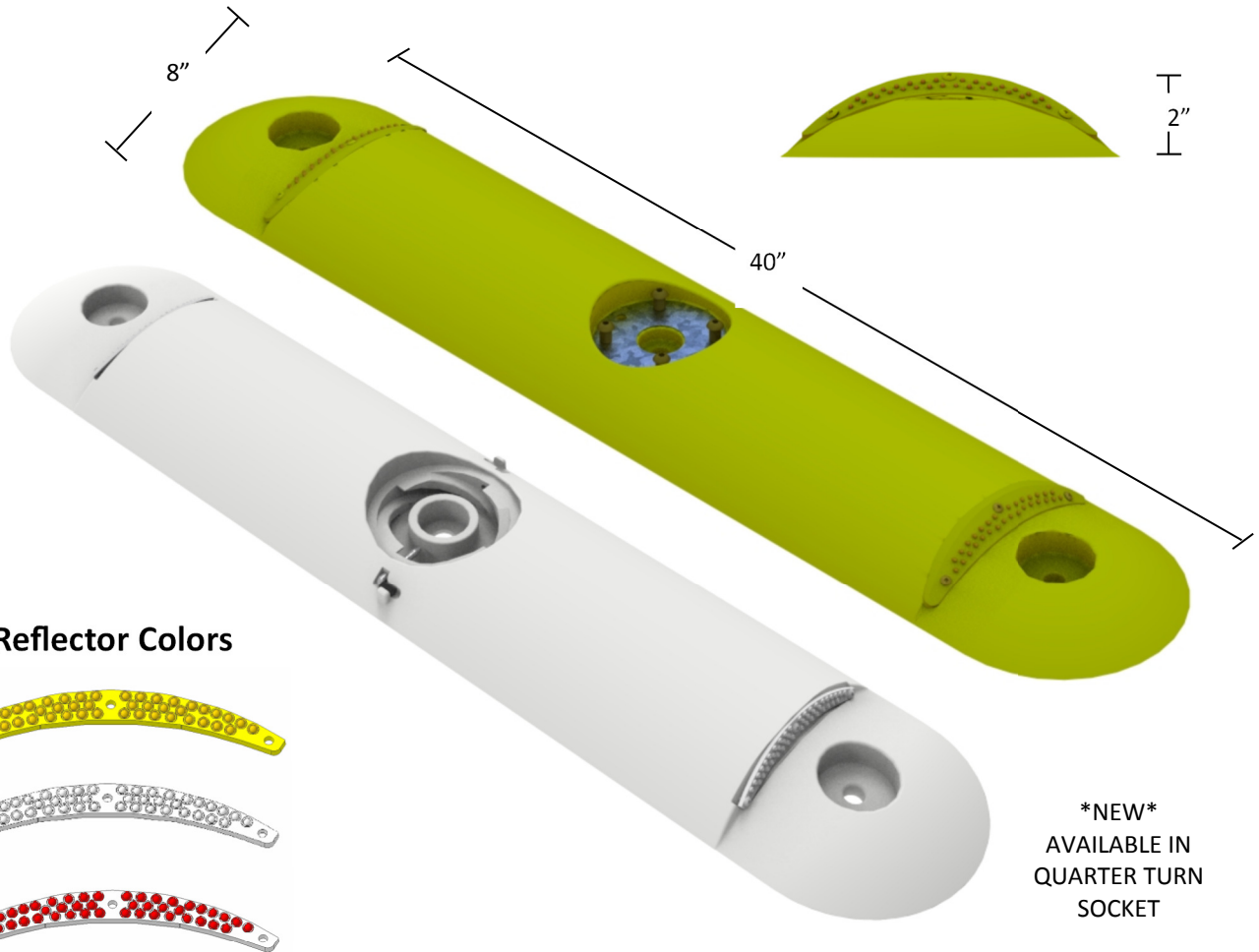

### Reflector Colors

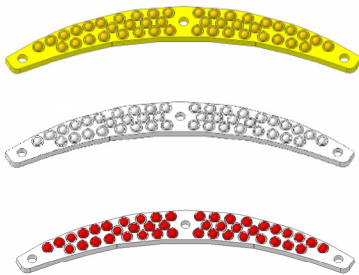

**\*NEW\***  
AVAILABLE IN  
QUARTER TURN  
SOCKET

### SPECIFICATIONS

- Tuff Curb® XLP is molded from a single piece of durable HDPE and utilizes IRS®'s patented reboundable spring post system
- Withstands 20,000 lbs. of static force from a single wheel
- Efficient installation with 2-3 mechanical anchors or epoxies
- Curved reflectors exceed ASTM D4280 min. reflectance levels
- 40" curb section weighs 6.5 lbs.
- MASH 2009 Accepted
- FHWA #WZ-304, WZ-317
- Available in Quick Release, Fixed, or Quarter Turn Sockets

### RECOMMENDED USES

- Ideal for use for demanding high speed applications as well as city streets, bridges, and parking decks
- Use with IRS® posts or signs attached
- See installation instructions for detailed usage recommendations

### AVAILABLE COLORS

- White (white or white/red reflectors)
- Yellow (yellow reflectors)
- Green (white or white/red reflectors)
- Other colors available on special order (minimum quantities required)

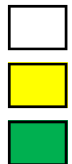

# Tuff Curb® XLP

## For Bike Lanes and Mixed Use Lanes

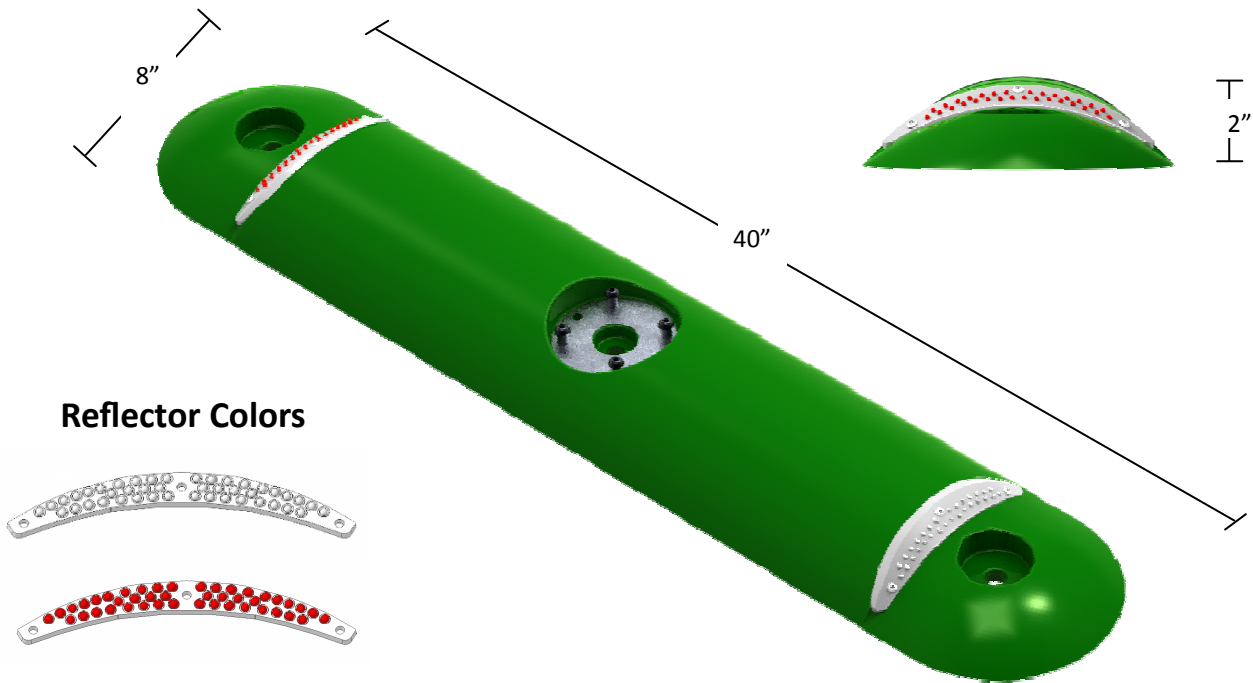

### Reflector Colors

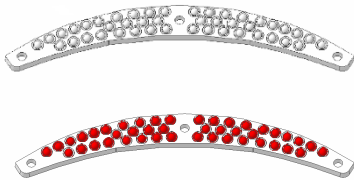

### SPECIFICATIONS

- Tuff Curb® XLP is molded from a single piece of durable HDPE & utilizes IRS®'s patented reboundable spring post system
- Withstands 20,000 pounds of static force from a single wheel
- Efficient installation with 2-3 mechanical anchors or epoxy
- Curb equipped with "Quick Release" feature which allows the upright to be removed from the base without the use of tools.
- Curved reflectors exceed ASTM D4280 min. reflectance levels
- 40" curb section weighs 6.5 lbs.
- MASH 2009 Accepted
- FHWA #WZ-304, WZ-317

### RECOMMENDED USES

- Green color for Bike Lanes and Mixed Use Lanes.
- Near vehicle turn and cross points in shared use paths.
- To delineate buffer zones of dedicated use lanes.
- Ideal for conventional, buffered, contra-flow, and raised cycle tracks.
- Use with IRS® posts or signs attached.
- Also available in white for lane line use.
- See installation instructions for detailed usage recommendations